

2.2 Monitor Unit

For the wiring of the monitor unit MU-190/231, see the operator's manual supplied with the monitor unit.

Mounting consideration

(Standard type)

- Connect the ECDIS main monitor to the DVI1 and COM1 ports.
- For the sub ECDIS monitor, connect it to the DVI2 and COM2 port.

(Conning type)

- ECDIS main monitor: DVI1 and COM1 ports, conning monitor: DVI3 port and COM2 ports
- When an ECDIS sub monitor is added to the above connection, connect it to the DVI2 port (the brilliance adjustment is not available).

(VDR connection, ask your dealer)

To connect a VDR, it is necessary to output data in analog format. See the installation manuals for VDR to prepare the cables (BNCX5-DSUB15-Lxxx and 1.5C2V-3C2V-T) to use.

- When connecting a VDR to the DVI3 port::
Use the optional DVI-BNCX5-L2000 cable to output RGB signal from the DVI-I. Adjustment of the output picture is necessary.
- When connecting a VDR to the DVI2 port:
Use a DVI/RGB converter (maker: IMAGENICS, type: DVI-12A, local supply) to convert DVI output from DVI2 port to RGB.

The [INSTALLATION SETTING] menu appears only when the power is turned on for the first time after installation of the monitor unit.

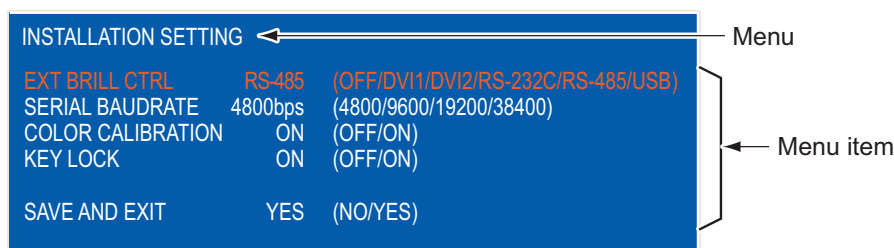

Adjust the settings referring to the following table.

EXT BRILL CTRL	SERIAL BAIDRATE	COLOR CALIBRATION	KEY LOCK	DVI PWR SYNC*
RS-485	4800bps	ON	ON	YES

*: [DVI PWR SYNC] is the slide switch at the bottom rear of the monitor unit. Confirm that this switch is set to [ON] (default setting). See Slide switch below for details.

2. WIRING

Slide switch

Set the slide switch to “ON” (default setting). This setting automatically powers the monitor unit on or off according to the DVI signal input. The power switch of the monitor unit is inoperative.

Note: The OFF position provides control of the monitor unit power with the power switch of the monitor unit.

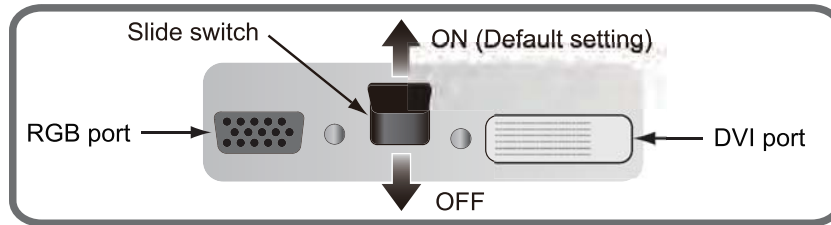

How to open the [INSTALLATION SETTING] menu

Turn off the monitor unit. While you hold the DISP key, press the BRILL key to turn on the monitor unit. Press and hold the DISP key for more than five seconds.

Note: When the [DVI PWR SYNC] slide switch is ON, turn on the connected external equipment while you press the DISP key to turn on the monitor unit.

BRILL CABLES FOR FMD-3200 & FMD-3300 ECDIS

MU-201/231CE: RS-232

DSUB9P-X2-A-L5M 001-252-580-10 5 Meter

DSUB9P-X2-A-L10M 001-252-590-00 10 Meter

Pin out:

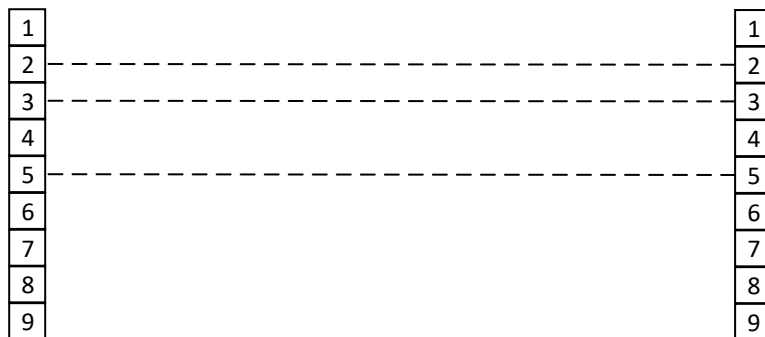

MU-190/231: RS-485

DSUB9P-X2-L5M 001-188-260-00 5 Meter*

DSUB9P-X2-L10M 001-188-270-00 10 Meter

***(STANDARD SUPPLY WITH FMD)**

Pin out:

